

Sugar mill chains

CONVEYOR CHAINS

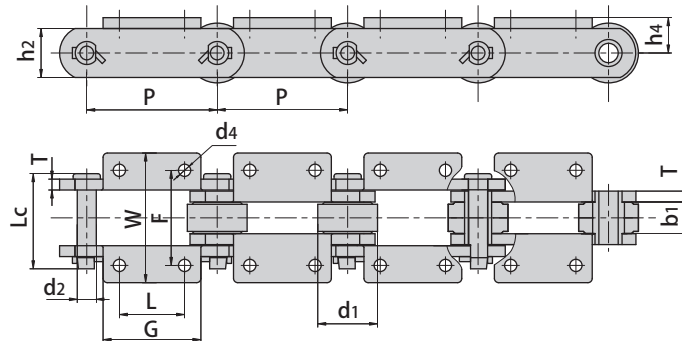

Donghua Chain No.	P	G	L	F	W	h4	d4
	mm	mm	mm	mm	mm	mm	mm
DH 9063	152.4	114.3	76.2	111.13	165.86	44.45	14.3
DH 2198	152.4	114.3	76.2	111.25	152.40	41.40	14.3
P152F93K2	152.4	110.0	76.2	111.00	146.00	44.50	14.3
P152F78K2	152.4	114.3	76.2	111.00	165.00	41.30	14.0

Donghua Chain No.	Pitch	Roller diameter	Width between inner plates	Pin diameter	Pin length	Plate depth	Plate thickness	Ultimate tensile strength	Average tensile strength	Weight per meter
	P	d1 max	b1 min	d2 max	Lc max	h2 max	T max	Q min	Q0	q
	mm	mm	mm	mm	mm	mm	mm	kN/lbf	kN	kg/m
DH 9063	152.4	76.20	38.1	23.83	103.2	61.00	10.30	445.0/100000	489.0	27.5
DH 2198	152.4	69.85	38.1	22.23	111.2	57.15	12.70	404.5/91000	445.0	27.9
P152F93K2	152.4	76.20	37.6	22.23	97.1	57.20	9.52	376.0/84500	410.0	26.2
P152F78K2	152.4	69.85	37.6	22.23	97.1	57.20	9.52	376.0/84500	410.0	26.2

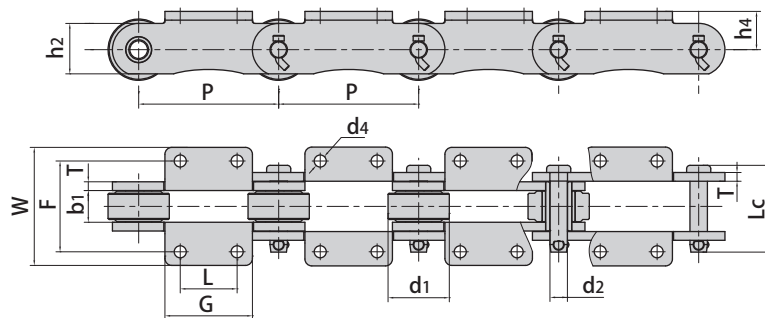

Donghua Chain No.	P	G	L	F	W	h4	d4
	mm	mm	mm	mm	mm	mm	mm
SM203.2F3K2	203.2	152.4	82.6	131.76	182.6	55.5	19.05
SM203.2F4K2	203.2	127.0	82.6	131.76	171.4	55.5	17.50
SM203.2F5K2	203.2	152.4	82.6	133.80	191.0	54.5	19.05

Donghua Chain No.	Pitch	Roller diameter	Width between inner plates	Pin diameter	Pin length	Plate depth	Plate thickness	Ultimate tensile strength	Average tensile strength	Weight per meter
	P	d1 max	b1	d2 max	Lc max	h2 max	T max	Q min	Q0	q
	mm	mm	mm	mm	mm	mm	mm	kN/lbf	kN	kg/m
SM203.2F3K2	203.2	88.9	46.0	25.32	126.0	71.4	12.7	520/116900	545.0	37.7
SM203.2F4K2	203.2	88.9	46.0	25.32	126.0	73.2	12.7	585/131513	614.0	35.9
SM203.2F5K2	203.2	88.9	46.0	25.32	126.0	70.0	12.7	480/107908	504.0	37.6

Sugar mill chains

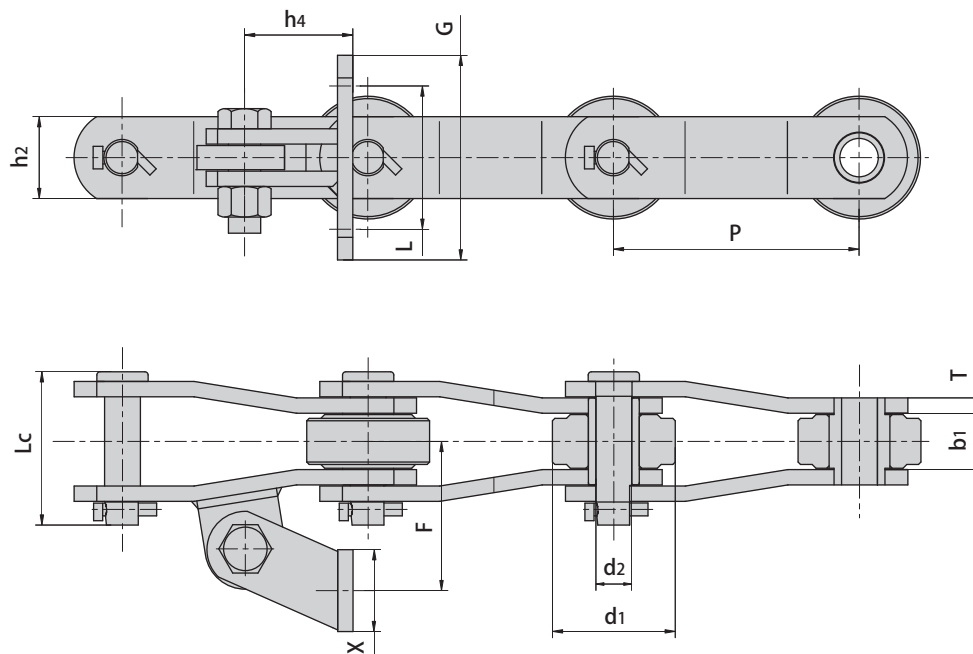

Donghua Chain No.	P	G	L	F	X	h4
	mm	mm	mm	mm	mm	mm
DH 09060	152.4	114.3	82.6	88.9	50.8	111.25
DH 1796	152.4	114.3	82.6	88.9	50.8	111.25
P152F77-AS2	152.4	127.0	88.9	92.1	50.8	66.80
P203.2F9	203.2	127.0	88.9	107.1	50.8	66.80

Donghua Chain No.	Pitch	Roller diameter	Width between inner plates	Pin diameter	Pin length	Plate depth	Plate thickness	Ultimate tensile strength	Average tensile strength
	p	d1 max	b1 min	d2 max	Lc max	h2 max	T max	Q min	Q0
	mm	mm	mm	mm	mm	mm	mm	kN/lbf	kN
DH 09060	152.4	69.85	38.1	19.05	96.6	50.80	9.65	270/60740	297.0
DH 1796	152.4	69.85	38.1	22.35	100.0	57.15	9.65	445/100100	489.5
P152F77-AS2	152.4	76.20	34.5	22.23	95.1	50.80	9.52	263/59120	280.0
P203.2F9	203.2	88.90	46.0	25.40	118.2	69.90	12.70	615/138257	640.0