

Conveyor chains with attachments (Z series)

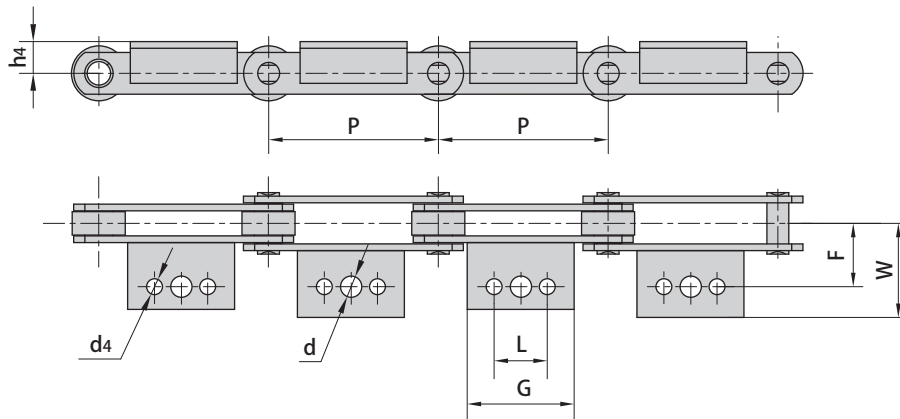

Donghua Chain No.		P	L	G	d	d4	F	W	h4	
		mm	mm	mm	mm	mm	mm	mm	mm	
Z40	△	50.8	-	45.0	10.7	9.3	38.1	64.5	19.0	
	△ ☆	63.5	22.2	43.0				56.0		
	△ ☆	76.2						68.0		
	▲	88.9	31.8	50.0				56.0		
	▲	101.6		64.0				55.0		
	▲	127.0		84.0				56.0		
	▲	152.4	57.2	84.0			56.0			
Z100	△	76.2	-	30.0	14.0	10.5	44.5	65.0	32.0	
	△	88.9								
	▲	101.6	31.8	64.0						
	△ ☆	127.0	57.2	84.0						
	▲	152.4		114.5						
	△ ☆	177.8	80.0	110.0						
△ ☆	203.2									
Z160	△	101.6	-	35.0	15.5	12.3	54.0	77.0	38.0	
	△ ☆	127.0								31.7
	△ ☆	152.4	57.2	84.0						
	△ ☆	177.8								
	△ ☆	203.2	100.0	130.0						
	△ ☆	228.6		150.0						
	△ ☆	254.0		170.0						
Z300	△	152.4	38.1	70.0	17.0	14.0	73.0	100.0	51.0	
	△	177.8								
	△ ☆	203.2	76.2	100.0						
	△ ☆	254.0	90.0	152.4						
	△ ☆	304.8	190.0	225.0						

△ Attachments with 1 hole
 ☆ Attachments with 2 holes
 ▲ Attachments with 3 holes